

DELHI IMPROVEMENT TRUST
 WESTERN EXTENSION KAROL BAGH
 LAY OUT OF BLOCK 16A.

SCALE:- 50'-0" TO ONE INCH.

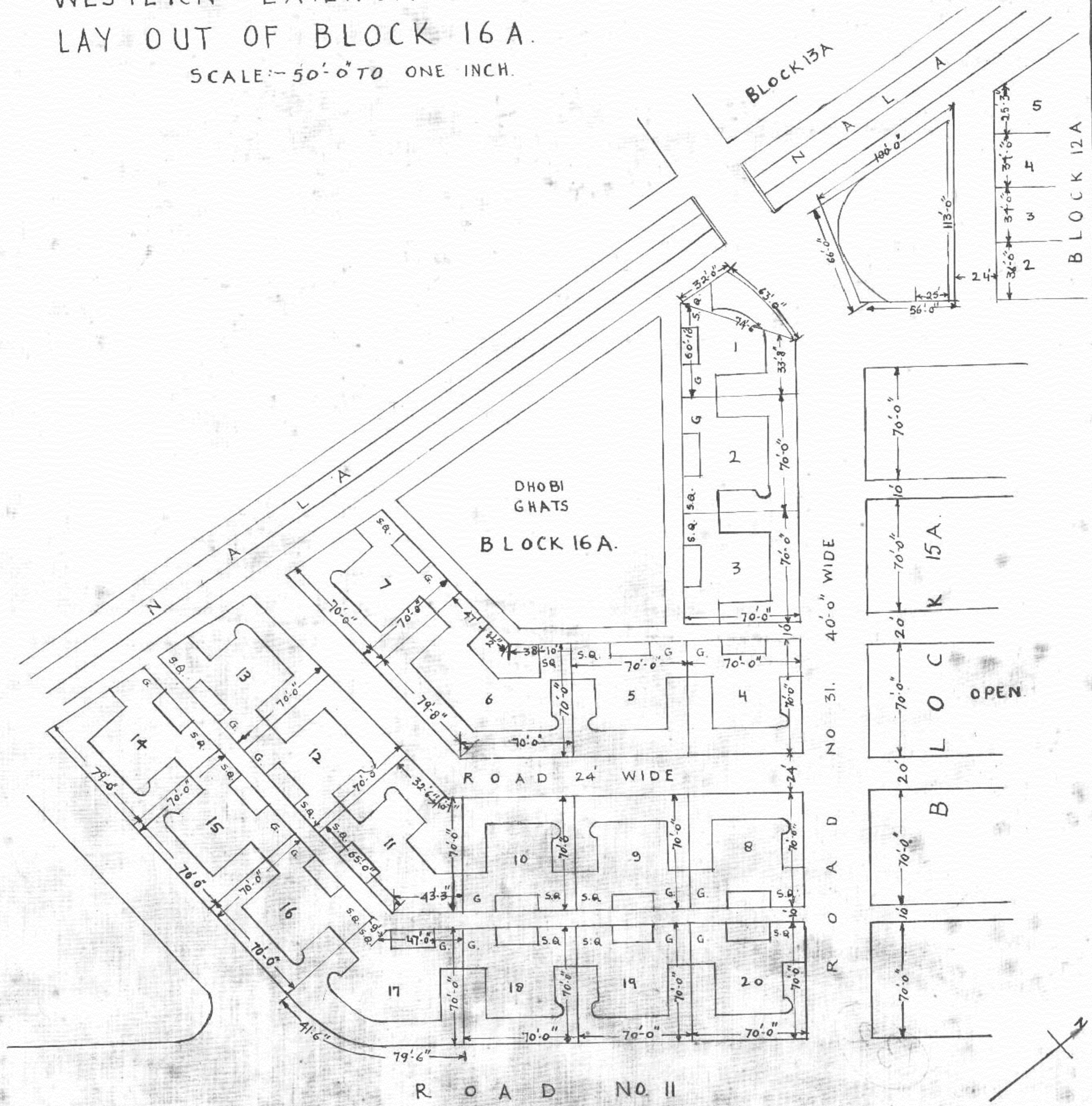

SITE FOR PRIMARY
 SCHOOL FOR GIRLS.

sd:- G.B. DEOLALIKAR.

A.R.I.B.A. (LON)

ARCHITECTURA ASSISTANT.
 DELHI IMPROVEMENT TRUST

I.T.A 62/1

M. Kumar Mittal
 25/11/69.
 RETRACED BY

Kishorendra
 & S. Gupta
 CHECKED BY ASSOC. PLANNER.

853